



# Sheraton Grand

LOS ANGELES



# Meeting Guide

## FUNCTION SPACE

- 1 The California Ballroom
- 2 The Wiltern
- 3 The Orpheum
- 4 The El Capitan
- 5 The Palace
- 6 The Los Angeles Theater

### BALLROOM LEVEL

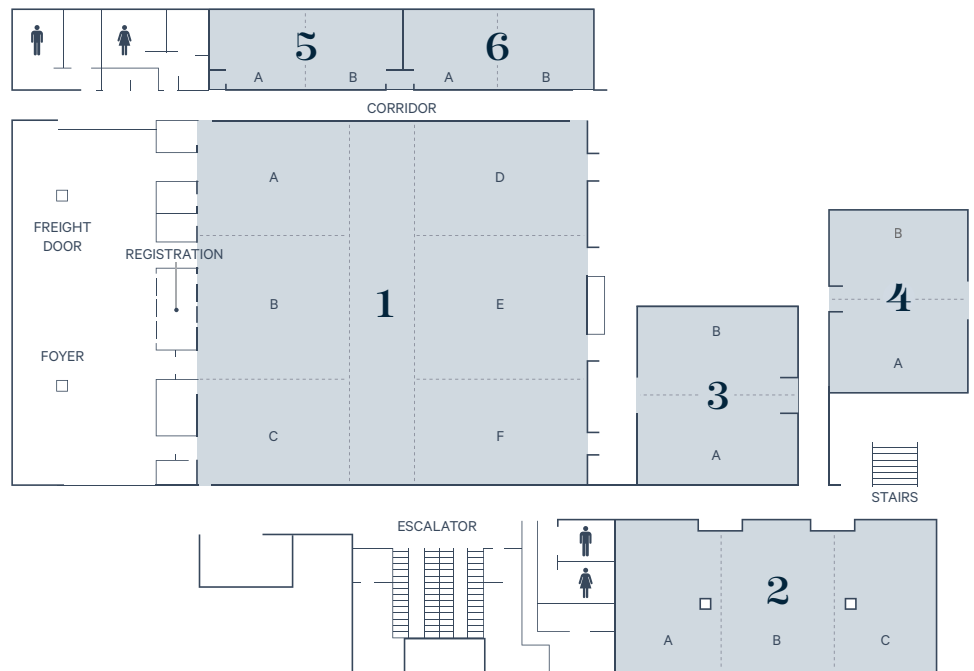

## ROOM DIMENSIONS AND SEATING CAPACITY - BALLROOM LEVEL

	SQ FEET	DIMENSIONS	HEIGHT	BANQUET	THEATER	RECEPTION	CLASSROOM	U-SHAPE	SQUARE	CONFERENCE
CALIFORNIA BALLROOM	10,000	100' x 100'	16'	700	900	900	650	-	-	-
THE WILTERN	3,444	84' x 84'	10'	200	280	200	150	-	-	-
THE ORPHEUM	2,000	40' x 50'	10'	110	120	120	80	-	-	-
THE EL CAPITAN	1,750	35' x 50'	10'	120	120	120	80	35	50	40
THE PALACE	840	22' x 40'	10'	70	70	50	40	30	30	30
LOS ANGELES THEATER	840	21' x 40'	10'	70	70	50	40	30	30	30

# Sheraton Grand Los Angeles

711 South Hope Street  
Los Angeles, California  
T 213 488 3500

sheraton.com/losangeles



## ROOM DIMENSIONS AND SEATING CAPACITY – BALLROOM LEVEL

	SQ FEET	DIMENSIONS	HEIGHT	BANQUET	THEATER	RECEPTION	CLASSROOM	U-SHAPE	SQUARE	CONFERENCE
CALIFORNIA FOYER	3,700	37' x 100'	10'	-	-	300	-	-	-	-
CALIFORNIA A OR B	1,353	42' x 33'	16'	90	100	160	80	30	40	30
CALIFORNIA C	1,148	42' x 28'	16'	90	100	100	70	40	30	30
CALIFORNIA D OR E	1,419	43' x 33'	16'	90	100	160	70	50	40	40
CALIFORNIA F	1,204	43' x 28'	16'	80	100	100	100	40	30	30
CALIFORNIA A/B	2,772	42' x 66'	16'	180	200	250	130	60	70	60
CALIFORNIA A/D	3,300	100' x 33'	16'	200	360	350	280	90	100	90
CALIFORNIA B/C	2,604	42' x 62'	16'	180	200	250	130	60	70	60
CALIFORNIA B/E	3,300	100' x 33'	16'	180	360	350	280	90	102	60
CALIFORNIA C/F	2,800	100' x 28'	16'	160	360	300	240	90	96	90
CALIFORNIA D/E	2,838	42' x 66'	16'	180	200	250	130	60	80	60
CALIFORNIA E/F	2,666	43' x 62'	16'	170	200	250	130	60	70	60
CALIFORNIA A/B/C #1	3,948	42' x 94'	16'	270	400	400	220	100	110	90
CALIFORNIA B/C/E/F	6,400	66' x 97'	16'	400	800	500	330	110	140	90
CALIFORNIA A/B/D/E	6,400	66' x 97'	16'	400	800	500	330	110	140	90
CALIFORNIA A/B/C #2 CORRIDOR	5,358	57' x 94'	16'	360	480	400	325	100	110	80
CALIFORNIA D/E/F #1	4,042	43' x 94'	16'	270	400	500	220	90	100	80
CALIFORNIA D/E/F #2 CORRIDOR	5,546	59' x 94'	16'	360	480	400	325	100	110	80
CALIFORNIA A/B/D/E	6,600	100' x 66'	16'	540	800	500	450	-	-	-
CALIFORNIA B/C/E/F	6,200	100' x 61'	16'	480	650	400	380	-	-	-
WILTERN A OR C	1,218	29' x 41'	10'	60	60	100	45	40	50	30
WILTERN B	1,066	25' x 41'	10'	60	60	100	45	-	-	24
ORPHEUM A OR B	1,000	40' x 25'	10'	60	60	60	45	25	25	16
EL CAPITAN A OR B	875	35' x 25'	10'	60	60	70	45	20	25	16
LOS ANGELES A OR B	440	22' x 20'	10'	70	30	32	24	-	-	15
PALACE A OR B	440	22' x 20'	10'	70	30	32	24	-	-	15

## ROOM DIMENSIONS AND SEATING CAPACITY – THIRD FLOOR

THE OVIATT	795	27' x 30'	9'	40	50	45	35	24	28	24
ROOM 316	600	26' x 26'	9'	-	-	-	-	-	-	14
ROOM 319	516	17' x 26'	9'	-	-	-	-	-	-	8
THE DECK	4,500	-	-	-	-	-	-	-	-	-

